



KLEIBERIT®

ADHESIVES • COATINGS

PUR-MAXX

ASSEMBLY BONDING MAXXIMAL

Operating manual **899.7 MAXXgun**



for cartridges

Competence **PUR**

Dear customer

Thank you very much for purchasing the KLEIBERIT 899.7 MAXXgun a cartridge glue gun.

This product enables you to glue parts together more easily and more rapidly. To achieve the best results read these instructions thoroughly before using the glue gun, keep these instructions available to refer back to them when needed.

Content

Product description

Correct use	3
Technical data	3

Trouble shooting

Possible reasons and problem solving	4
--------------------------------------	---

General safety instructions

User's care and diligence	5
Keep instructions	5
Safety symbols	5
Safety measures for normal use	6

Start up **7**

Handling

Glue application	8
Loading cartridge	8
Cleaning nozzle and nozzle adaptor	9
Pre heat cartridge	9

Check list for safe operation

Checks before plugging in	10
Checks during working process	10
Checks after working process	10

Customer service **11**

Warranty	11
Contact	11



Product description

Correct use

The glue gun heats up the hot melt which is then pressed out of the glue gun with manual pressure. Please note that the glue gun should only be used by competent personnel. Correct usage reduces the risk of accidents and bonding problems.

All damage and inquiries as a result of incorrect use are not the responsibility of the manufacturer, but are the responsibility of the user.

Technical Data

Connection	230 V/50 Hz
Heating capacity	120 W max.
Temperature	approx. 130 °C (at the nozzle tip)
Temperature control	automatic thermostat
Pre heat time	approx. 25 min
Cable length	2 m
Speed	approx. 3 mm per compress
Application	beads and spots
Weight	1240 g
Cartridge size (l x diameter)	110 x 47 mm
Cartridge content	140 g

PUR-MAXX

Heating element to pre heat the glue cartridges to approx. 130 °C

Cartridge bed for easy cartridge loading

Aluminum nozzle with leak protection for bead and dot application

Robust feed mechanism with plunger

Hanging hole

Rubber coated, ergonomic handle

Smooth release button





Curved plunger for hanging



Trouble shooting

Possible reasons and problem solving

If a problem can not be solved, the glue gun must be sent in the KLECHEMIE M.G. Becker GmbH & Co. & KG. Attempted repairs by un-authorized persons will void the product warranty.

Problem	Possible reason	Trouble shooting
<ul style="list-style-type: none"> No temperature 	<ul style="list-style-type: none"> Glue gun switched off Cable damaged Defective fuse 	<ul style="list-style-type: none"> Check if cable is plugged in correctly Check cable Replace fuse
<ul style="list-style-type: none"> None or insufficient adhesive flow from the nozzle, after the correct pre heat time 	<ul style="list-style-type: none"> Nozzle / nozzle adaptor blocked Temperature too low Cartridge blocked 	<ul style="list-style-type: none"> Unscrew and clean or replace nozzle/ nozzle adaptor  <p>(Risk of burning !) Wear protective gloves</p> <ul style="list-style-type: none"> Check Temperature Replace cartridge
<ul style="list-style-type: none"> Leaking nozzle 	<ul style="list-style-type: none"> Pressure too high in cartridge Nozzle blocked Spring pressure of the nozzle ball value is too weak 	<ul style="list-style-type: none"> Use yellow load release button Unscrew and clean or replace nozzle  <p>(Risk of burning !) Wear protective gloves</p> <ul style="list-style-type: none"> Replace nozzle
<ul style="list-style-type: none"> Adhesive presses out of the back of the cartridge 	<ul style="list-style-type: none"> Temperature too low Nozzle blocked Exit pressure is too high The load release button does not get into place 	<ul style="list-style-type: none"> Check temperature Unscrew and clean or replace nozzle  <p>(Risk of burning !) Wear protective gloves</p> <ul style="list-style-type: none"> Reduce pump speed Press yellow load release button and try again
<ul style="list-style-type: none"> No glue discharge from the nozzle after a prolonged down time with a hot cartridge 	<ul style="list-style-type: none"> Glue is dried up in the nozzle 	<ul style="list-style-type: none"> Unscrew and clean or replace nozzle  <p>(Risk of burning !) Wear protective gloves</p> <ul style="list-style-type: none"> Replace cartridge



General Safety Instructions

User care and diligence

The **KLEIBERIT 899.7 MAXXgun glue gun** has been designed and manufactured in accordance the corresponding standards and additional technical specifications. This glue gun is state of the art equipment which provides a maximum of safety.

A optimal safe handling in practise however can only be achieved if all the necessary safety measures are adhered to. It is the responsibility of the user and owner to ensure the all safety measures are adhered to.

The user / owner has to ensure that:

- the gun is in good working order
- the required personal protective equipment (protective gloves and goggles) are available
- the instruction manual is in a legible condition and is available to the person using the gun
- only competent and authorised personnel should operate and maintain the glue gun
- this personnel should be receiving continuous competence training in all aspects of work place and environmental health and safety as well as be converse with the operating instructions of this gun

Ensure information is available

These operating manual should be kept where the gun is used. It should be ensured that all personnel operating the gun have access to the operating manual. In addition to the operating instructions, personnel must be instructed on the safe handling of work place equipment.

Meaning of various safety symbols

This operating manual contains safety symbols which draw the users attention to the unavoidable risks when using this gun. These risks are endangering

- Personnel
- Equipment and material

The symbols used in these operating instructions shall draw attention to the safety notices.



Hazardous!

Accident Prevention Regulations VBG 125 / W09

This symbol indicates that there is predominately a risk for persons, but also a risk for equipment and material.



Caution! Hot surface!

Accident Prevention Regulation VBG 125 / W26

Hot surfaces, such as hot equipment parts, containers or materials, as well as hot liquids, which can not always be detected.

If such a symbol is on the equipment utmost caution is advised.

Do not touch hot surfaces without protective gloves.

General Safety Instructions

Safety measures for normal operations

The equipment must only be used by authorised persons, which have been trained and instructed on the safe use of the equipment. These persons should be familiar with the operation instructions and be able to follow these.

Prior to each use, the gun should be inspected for visible damage, and it must be ensured that it is in perfect condition. Defects must be reported to the supervisor immediately!



Safety instructions for the use of the glue gun

- After pre heating the nozzle and the nozzle adaptor, the heating element, both cross beams and the cap nuts and the piston are extremely hot.
- Never use without the nozzle / nozzle adaptor.
- Before place cartridge in the glue gun push open the cartridge top and remove the cartridge bottom.
- Do not direct the adhesive bead towards persons.
- When replacing the nozzle / nozzle adaptor hot liquid adhesive may leak out. Caution Risk of burning!
- Never bring hot equipment parts in contact with the cable.
- If hot adhesive got in contact with skin:
Cool immediately with cold water. Do not attempt to remove the adhesive, if necessary consult a doctor.
- If hot adhesive got in contact with eyes:
Immediately cool with cold running water for approx. 15 min, immediately consult doctor.
- Work with protective gloves.



- Work with protective goggles.



- After disconnecting the power, allow the hot gun to cool down to room temperature.
- Never leave the hot gun or the pre heated cartridges unattended, or pack the equipment away whilst still hot.

Note:

- do not leave gun unattended
- do not direct adhesive bead towards persons
- only work with attached nozzle / nozzle adaptor
- do not work overhead
- stop using the gun if it is damaged from to impact, breakage or worn out from extensive use



Operation

1. Ensure that the plug is not in the socket.

2. Prepare the cartridge

- Remove the cartridge bottom. For this use the **KLEIBERIT MAXXopener**.

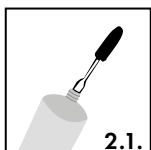

- Open cartridge top by puncturing (pic 2.1.)

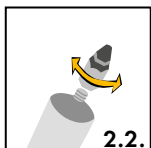

- Attach nozzle / nozzle adaptor (pic 2.2.)

3. Insert cartridge with attached nozzle / nozzle adaptor

- Press yellow release button
- Pull back the piston

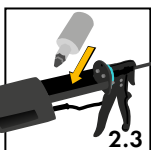

- Insert cartridge (with attached nozzle / nozzle adaptor) in to the cartridge bed and push into the heating element (pic 2.3.)

- Push the piston far enough into the gun to avoid the cartridge falling out. The piston plate should stop approx. 0.5 cm before the cartridge.

Warning!

The adhesive will expand slightly during heating up, therefore until the working temperature is reached (approx. 25 min) do not press the piston. Otherwise the glue will leak from the nozzle, if necessary press the yellow load release button and pull the piston back.

Only use undamaged cartridges (no dents or other damages) so that the piston can move freely.

4. Plug the equipment in



Caution - risk of burning! The heating element is now pre heating the cartridge, adjacent equipment parts will also become hot.



The nozzle, the heating element and both cross beams with the cap nuts and the plunger are extremely hot after preheating.



Work with protective gloves.



Work with protective goggles.



To avoid the danger of stumbling, lay cable in such a manner that there is no risk of stumbling.

Handling

Applying the hot melt

Familiarise yourself with the equipment. To extract the molten adhesive pull the lever. The stronger the pull the more adhesive will be pushed out of the nozzle. To practise apply the adhesive onto a piece of carton to vary the glue bead. This is easily done.



Caution – Risk of burning!



Work with protective gloves and goggles.

If hot adhesive gets in contact with skin cool immediately with cold water.

Do not first try to remove the adhesive from the skin.

If necessary consult a doctor.

If hot adhesive gets in contact with eyes, cool eyes immediately for approx. 15 min cold running water.

Consult doctor immediately!

Only work with the nozzle attached! Never direct the gun towards persons!

Nozzle replacement

Cartridge can be replaced when gun is hot or cold.



Caution – Risk of burning!



Work with protective gloves and goggles.

If a different grade of adhesive is being used the nozzle should be flushed through (see cleaning of the nozzle / nozzle adaptor).

If an empty cartridge is being replaced with a full cartridge, follow these steps:

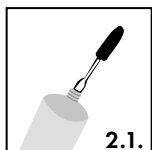

- Remove cartridge bottom and open cartridge top (see prepare the cartridge)

- Press yellow load release button and pull back the piston.
- Remove empty cartridge. Caution – risk of burning!
- Remove nozzle from empty cartridge and attach to the full cartridge.

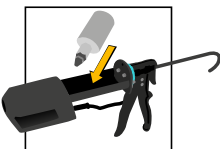

Insert cartridge (with attached nozzle / nozzle adaptor) in to the cartridge bed and push into the heating element (pic 2.3.)

- Push the piston far enough into the gun to avoid the cartridge falling out. The piston plate should stop approx. 0.5 cm before the cartridge.
- Preheat time is approx. 25 min, wait until the adhesive in the new cartridge is molten (see insert cartridge with nozzle / nozzle adaptor attached)



Handling

Cleaning of the nozzle / nozzle adaptor

Before longer break in usage (max. 24 hrs) the nozzle / nozzle adaptor has to be cleaned. For this use the cleaner cartridge **KLEIBERIT 761.7 CleanMAXX**.

Generally remove the nozzle / nozzle adaptor from the warm cartridge (see cartridge replacement)



Caution – Risk of burning!



Work with protective gloves and goggles.

- Preheat time of approx. 25 min, wait until the cleaner is molten.
- Push cleaner through the nozzle until an even light blue bead appears (approx. 2-3 level pulls)
- Remove cleaner cartridge with attached nozzle (see cartridge replacement).
- Remove nozzle / nozzle adaptor from the warm cleaner cartridge.

Allow cleaner cartridge to cool down, and safe for further use. The opened cleaner can be used for up to 6-8 weeks.

Preheat cartridge

If it can not be determined at which time the glue gun is used the closed cartridge can be preheated in the gun.

Depending on the type of adhesive the cartridge the adhesive can be used after approx. 25 min. Take out the hot cartridge from cartridge bed and remove the cartridge bottom. Open the top of the cartridge, and attach the nozzle / nozzle adaptor (see cartridge preparation). Afterwards insert the hot cartridge into the cartridge bed.



Caution – Risk of burning!



Work with protective gloves and goggles.

To permanently preheat cartridge we recommend the use of the cartridge preheater **KLEIBERIT MAXXpreheater**.

Checklist for use and handling

The **KLEIBERIT 899.7 MAXXgun** must only be used for the purpose it is intended for. Please note the general safety instructions.

If the equipment is not used appropriately damage to persons and equipment may occur. Not following the safety instructions for handling the equipment may result in bad burns and other injuries.

Before connecting the equipment to power carry out the following function checks:

Check before power connection

- Check that nozzle / nozzle adaptor are clean, (no adhesive remnants or other blockages)
- Only squeeze out adhesive from cartridges with cartridge bottoms removed and cartridge tops opened
- Only use cartridges with attached nozzle / nozzle adaptor
- Only use undamaged cartridges
- Do not insert empty cartridges
- Check that all mechanical parts are moving without problems
- Ensure that the gun is standing safely, use the **KLEIBERIT MAXXbase**
To avoid person and material damage never leave the hot adhesive gun or hot cartridges unattended.

Check during working process

- Observe the preheat time of approx. 25 min
- Using the lever requires only little pressure. Overexerting pressure and forcing the gun will void the warranty.
- Ensure the gun is standing safely

Note:

- Ensure the gun is standing safely
- Do not point adhesive bead towards persons
- Only work with nozzle / nozzle adaptor attached
- Do not work overhead
- Stop using the gun if it is damaged from to impact, breakage or worn out from extensive use

Check after work process

- Remove plug from power outlet
- The nozzle has to be cleaned for longer processing breaks (max. 24 hrs) to avoid adhesive curing in the nozzle and making the nozzle unusable. Cured adhesive can only be removed mechanically.



Customer services

In the unlikely event of a problem check your equipment in accordance with the trouble shooting guide before making a claim. And when making a claim quote the model and serial number of the equipment.

KLEBCHEMIE M. G. Becker GmbH & Co. KG

Typ: 899.7 MAXXgun
SNr: B39E017
230 V ~ 50 Hz 120 W max.

CEwww.kleiberit.com

Guarantee

This product has been manufactured to a high quality standard and is guaranteed against faulty materials and workmanship for 6 months from date of purchase, in an authorised dealership. This guarantee does not cover defects caused by or resulting from misuse, abuse or neglect, repairs attempted by anyone other than an authorised repairer or damages caused by foreign objects, substances or accident. After the guarantee period all material, labour and freight costs are to be borne by the customer.

Changes which serve technical development are subject to alterations. Errors or printing errors in these instructions are excepted.

Contact

We are happy to provide any further information you require:

KLEBCHEMIE

M. G. Becker GmbH & Co. KG
Max-Becker-Str. 4
76356 Weingarten/GERMANY
Phone: +49 7244 62-0
Fax: +49 7244 700-0
Email: info@kleiberit.com
www.kleiberit.com

KLEBCHEMIE

M. G. Becker GmbH & Co. KG
Max-Becker-Str. 4
76356 Weingarten/GERMANY
Phone: +49 7244 62-0
Fax: +49 7244 700-0
Email: info@kleiberit.com